

Princess F45

£929,950

Year **2023** 

Lying **Calvià, ES** 

Ref **PB2417** 



OPEN TO PART EXCHANGE • PRINCESS TECHNICAL ORIENTATION INCLUDED

PROFESIONAL PHOTOGRAPHY COMING SOON

2024 Model • Twin Volvo IPS 650 (2x 480hp each) diesel engines • 2 cabins accommodating 4 guests • White hull • Whisperpower 9.6kW generator • Bow thruster • Reverse air-condition and heating • Garmin navigation equipment • Electro-hydraulic swimming platform • Teak with black caulking to flybridge deck and side decks • Upgraded external light package • Flybridge wetbar • Flybridge bimini top in Grey • On-board WiFi network inc external WiFi and 3G/4G antenna • Fusion Apollo and waterproof Fusion speakers

PLEASE CONTACT US FOR MORE INFORMATION ON THIS PRINCESS F45 SPORTS CRUISER FOR SALE

Princess F45

£929,950

Year **2023** 

Lying **Calvià, ES** 

Ref **PB2417** 

Specification

- **Length** 14.35m / 47ft 1in
- **Beam** 4.24m / 13ft 11in
- **Engine hours** 75
- **Hull colour** White gel coat hull
- **Hull material** Fiberglass
- **Number of engines** 2
- **Fuel type** diesel
- **Total power** 960.0 hp

Navigation Equipment

- Bowthruster (120Kgf) with dual station controls
- Garmin GMR 424 XHD2 digital colour radar with 48", 4Kw scanner
- Second Volvo/Garmin 16" colour multifunction display fitted at lower helm position
- Garmin (GMI 20 colour) 4" multifunction display at lower helm (separate display and control of individual functions e.g. log & echo sounder)
- Second Volvo/Garmin 16" colour multifunction display at the upper helm
- Garmin (GMI 20 colour) 4" multifunction display at the upper helm (separate display and control of individual functions e.g. log and echo sounder)
- European version plotter charts
- International VHF

Deck Equipment

- Electro-hydraulic swimming platform (400Kg SWL - maximum advised tender weight 150Kg)
- Dinghy chock system
- Teak with black caulking (6mm) to flybridge deck
- Additional 10m of galvanised 9.5mm anchor chain to give a total of 50 metres
- 20kg stainless steel Lewmar Epsilon anchor with stainless steel Lewmar swivel
- Upgraded exterior lighting package which includes additional deck lights to flybridge, side decks and foredeck area (8), pop-up lantern to flybridge forward dinette (1)
- Flybridge bimini top in Grey
- Rear cockpit privacy screen
- Forward deck sun cushions and covers
- Seat overhang in place of locker
- Sliding window to portside of saloon
- Cockpit seat has powered sliding mechanism with infill cushion (increases length of cockpit by 400mm)
- Aft canopy feature chamfer - Electric Blue
- Flybridge wet bar incorporating hot and cold sink, electric griddle/BBQ, waste bin and top loading coolbox

Princess F45

£929,950

Year **2023** 

Lying **Calvià, ES** 

Ref **PB2417** 

- Mosquito screens for all opening portlights
- Fitted with reticulated foam to all standard exterior cockpit & flybridge seating
- Exterior covers in Grey Canvas

Interior Fitout

- Master cabin with double berth
- Forward cabin with scissor berth conversion
- Deck saloon table with ability to convert to double berth
- Walnut interior wood satin finish
- Galley floor is in V groove planked Walnut
- Galley worktop in Carrara White Gloss finish
- Bathroom vanity tops are Carrera White Solid Surface (gloss finish) with Koko White solid surface (satin finish) floors
- Lower helm console has an Anthracite Grey finish
- Helm seats are upholstered in Quartz III Putty leather

Interior Equipment

- Combination washing machine-dryer fitted below companionway stairs in Master cabin
- Princess China (5 piece set consisting of plate, side plate, bowl, cup and saucer)
- 6 place settings
- Princess Glasses (6 wine, 6 tumblers)
- David Mellor 'Paris' cutlery (6 pieces, 6 settings)
- Electric hob

Broker Comments

The owner only took delivery spring of 2025. Prior to this, this boat had been the demonstration of Princess Motor Yachts. The owner feels that he would like to move to a smaller craft. This boat is present in superb condition and has a very nice level of spec. The two cabins and two sets of heads/showers create a fantastic interior, well appointed for two plus two cruising.

Disclaimer

In this case we are acting as Brokers only.

The Vendor is not selling in the course of a business. Whilst every care has been taken in their preparation, the correctness of these particulars is not guaranteed. The particulars are intended only as a guide and they do not constitute a term of any contract.

Princess F45

£929,950

Year **2023** 

Lying **Calvià, ES** 

Ref **PB2417** 

A prospective buyer is strongly advised to check the particulars and where appropriate at his own expense to employ a qualified Marine Surveyor to carry out a survey and/or to have an engine trial conducted which if conducted by us shall not imply any liability for such engine on our part.



PRINCESS
BROKERAGE INTERNATIONAL
EST 1964
OUR KNOWLEDGE IS YOUR LUXURY

> **OPEN TO PART EXCHANGE**
WE CAN HELP SPEED UP THE SALE THROUGH OUR OFFER TO UNDERWRITE A PART-EXCHANGE AGAINST THE BROKERAGE YACHT

> **PRINCESS TECHNICAL ORIENTATION INCLUDED**
AT NO ADDITIONAL COST, REGARDLESS OF WHERE THIS YACHT IS LOCATED, WE OFFER A COMPREHENSIVE TECHNICAL INTRODUCTION TO YOUR PURCHASE

> **PROFESSIONAL PHOTOGRAPHY, VIDEO & 3D TOUR AVAILABLE**
VIEW IMAGERY, VIDEO AND A 3D TOUR/WALKTHROUGH OF THIS YACHT ONLINE

PRINCESS
BROKERAGE INTERNATIONAL

brokerage@princess.co.uk
+34 (0)969 657765
www.princessmotoryachtbalears.com



Princess F45

£929,950

Year **2023** 

Lying **Calvià, ES** 

Ref **PB2417** 



Princess F45

£929,950

Year **2023** 

Lying **Calvià, ES** 

Ref **PB2417** 

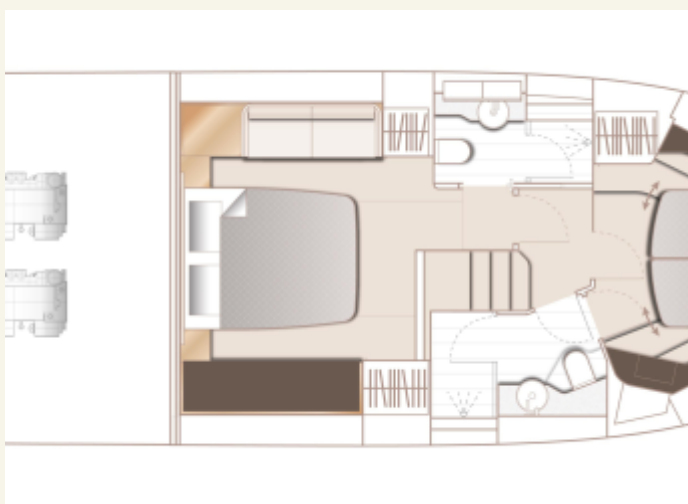
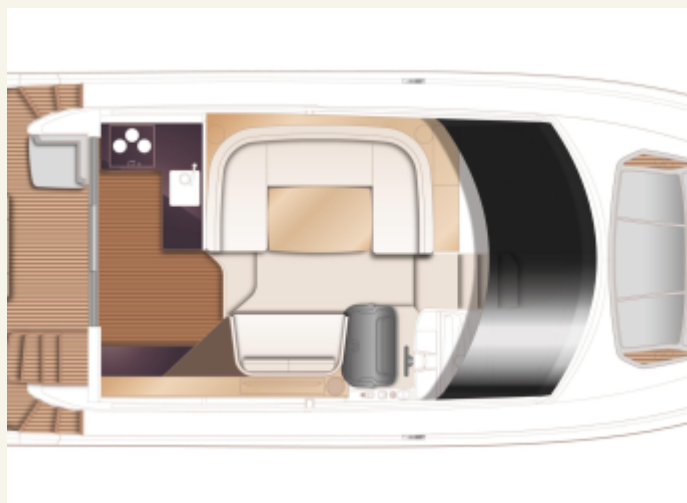
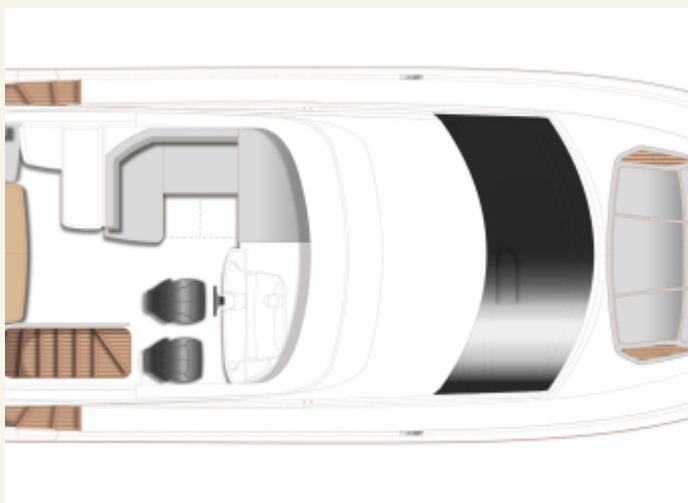

**FINANCE AND INSURANCE
AVAILABLE ON THIS
PRINCESS YACHT**

Contact
finance@princess.co.uk
insurance@princess.co.uk
for information.

PRINCESS
OFFICIAL BROKERAGE
FOR SPAIN / PORTUGAL / TURKEY

PRINCESS MOTOR YACHT SALES

